

EVERHOT®

Hot Water Solution



Made by Rheem Manufacturing

- ✓ Great Value
- ✓ Great Quality
- ✓ Australian Brand

Everhot. Job Done!



DOMESTIC ELECTRIC STORAGE MAIN PRESSURE



ELECTRIC

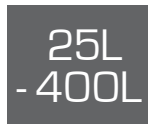

DELIVERY

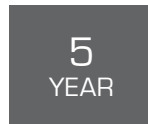

CYLINDER
WARRANTY



INSTALLATION

Everhot electric storage hot water heaters feature a durable vitreous enamel lining, and reliable performance you expect from a product manufactured by Rheem. They offer outstanding value, and come in a wide range of models with a capacity to suit any domestic application.



FEATURES

- Complete model range (25L – 400L)
- Fast, easy like-for-like replacement
- Indoor or outdoor use
- Sacrificial anode
- Mains Pressure
- 25L - 90L feature compact dimensions and wall-hung bracket included
- 5 year cylinder warranty & 1 year spare parts
- Elements available 1.2kW, 1.5kW, 3.6kW, and 4.8kW

WHY EVERHOT ELECTRIC?

- **Designed for Australia's tough conditions** using over 80 years of experience in Australia
- **Sizes to suit every family** and hot water requirement from 25L to 400L
- **Main pressure** the ability to service multiple uses at once without losing hot water pressure
- **Full technical support and spare parts available**
- All Everhot electric water heaters are made in a wholly owned and operated Rheem facility



Made by Rheem Manufacturing

EVERHOT[®]
Hot Water Solution

SPECIFICATIONS		25L	40L	60L	90L	120L	150L	195L	270L	320L	400L
Model Name		ERAS02503 ERAS04003 ERAS06003 ERAS09003 ERAS12003 ERAS15003 ERAS19503 ERAS27007 ERAS32007 ERAS40007									
Model Name		ERAS02503G ERAS04003G ERAS06003G ERAS09003G									
Hot Water Delivery	Litres	25	40	60	90	120	150	195	270	320	400
Floor Standing Type	upright	✓	✓	✓	✓	✓	✓	✓	✓	✓	✓
Wall-hung Type	upright	✓	✓	✓	✓	-	-	-	-	-	-
Rated Power	kW	1.5 1.2 ; 1.5 ; 2.4 ; 3.6 ; 4.8 (~ 220 V - 50 Hz)									
Rated Current	A	6.8 5.5 ; 6.8 ; 11 ; 16.5 ; 22									
T & PR Setting Pressure	kPa	850									
Max Water Supply Pressure	kPa	680									
Adjustable Water Tem/ Range	°C	30 ~ 70 (Factory Setting at 65)									
T & PR Connections		RP $\frac{3}{4}$ /20									
Cold & Hot Water Connections		RP $\frac{3}{4}$ /20									
Dimensions											
A	mm	440	454	614	864	1114	1364	1714	1482	1759	1900
B	mm	256	220	380	630	880	1130	1480	1318	1480	1708
C	mm	66	114	114	114	114	114	114	145	145	145
D	mm	370	458	458	458	458	458	458	569	569	610
E	mm	162	68	68	68	68	68	68	68	68	68
G	degrees	29	22	22	22	22	22	22	29	29	29
H	mm	404	492	492	492	492	492	492	603	603	644
Approx. Weight (Empty)	kg	13	22	27	34	42	49	58.5	70	79	102

* Each model of electric water heaters can be fitted with five type of heating units: 1.2 kW, 1.5 kW, 2.4 kW, 3.6 kW, 4.8 kW, and the matched minimum section acreage of copper core main power wire is of 1.0mm², 1.0mm², 1.5mm², 2.5mm², 4.0mm² respectively.

SIZING GUIDE

No. of People	Model
1	25 litre
1-2	40 litre
1-3	60 litre
2-3	90 litre
3-4	120 litre
4-5	150 litre
5-6	195 litre
6-7	245 litre
7-8	270 litre
8-9	320 - 340 litre
9-11	400 litre

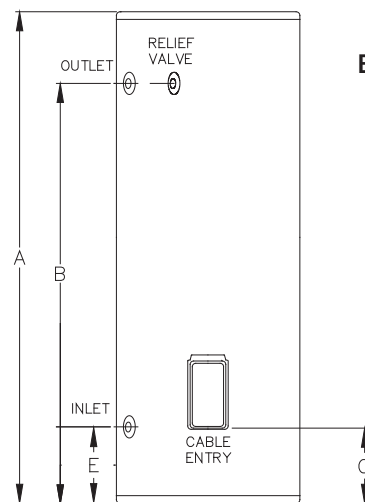
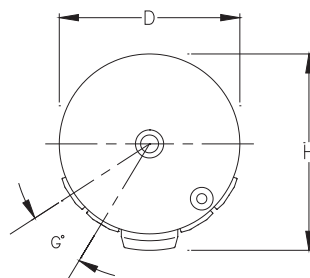

25L – 400L
Electric Models

COLORBOND JACKET

Resist dirt rust and corrosion proof

SACRIFICIAL ANODE

Longer Lifespan

EVERGLAS VITREOUS ENAMEL LINING

Corrosion proof

POLYURETHANE INSULATION

Keep the water hotter

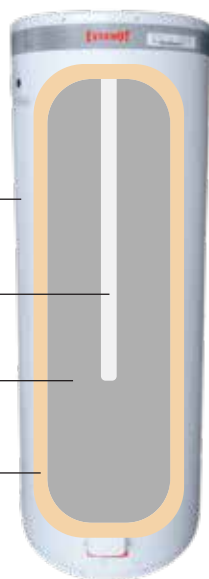

Warranty: 5 Years on Cylinder, 1 Year Parts & Labour warranty on all other components for Domestic (non-Commercial) installations. Conditions apply. See the Everhot warranty set out in the Owner's Guide and Installation Instructions.